

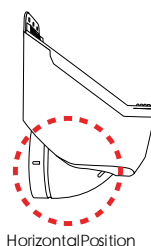

Products: Leaf Eater Advanced

Code: RHAD99 – 3" Round
RHAD98 – 4" Round

The Next Generation in Rain Heads.



Horizontal Position

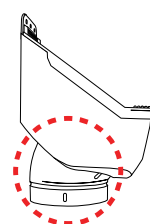

Vertical Position

Product Description

The Leaf Eater Advanced™ is the next generation Rain Head, featuring the new patented Cleanshield™ (single screen) technology and VH Pivot™ outlet. The Leaf Eater Advanced™ Rain Head prevents debris from entering the Rain Harvesting system, improves water quality and reduces tank maintenance. The single screen incorporates Cleanshield™ technology which deflects leaves and debris away from the flow of water. This minimises maintenance and enhances catchment efficiency. This Rain Head incorporates a VH Pivot™ outlet that swivels to suit vertical or horizontal downpipes. The Leaf Eater Advanced™ can also be used as a debris removing device even when rainwater is not being collected.

Features and Benefits

- Compact, versatile rain head for quick and easy installation
- Patented single screen technology for advanced debris shedding (Cleanshield™)
- Minimal maintenance – the screen automatically sheds debris
- Superior catchment efficiency at low and high flow rates
- Pivot the outlet to suit vertical or horizontal (rear outlet) downpipes – variety of installation options in one product (VH Pivot™ patent pending)
- High flow rate performance
- Single screen with 0.955mm aperture mosquito proof stainless steel mesh
- Available in 3" or 4" outlet

Compliance

- Queensland Development Code MP 4.2 – Water Saving Targets
- AS/NZS 3500.3:2003 Plumbing and Drainage – Stormwater Drainage
- HB230:2008 Rainwater Tank Design and Installation Handbook
- enHealth Council – Guidance on the Use of Rainwater Tanks – Preventing Mosquitoes Breeding
- Queensland Health Regulations 1996 (Part 8 – Mosquito Prevention)

Installation

Gutter & Mid-Mount Installation

1. Gutter: Measure 208mm from the bottom of the existing gutter pop and remove this section of downpipe. Ensure the cut edge is clean and smooth. Mid-Mount: Remove 208mm of downpipe where the Leaf Eater Advanced™ is to be situated. Ensure all cut edges are clean and smooth. (figure 1)
2. Using the quick release tabs remove the Cleanshield™ screen by lifting it up and then out. (figure 2)
3. Insert the Leaf Eater Advanced™ by sliding it up over the cut section and then down into position. The Leaf Eater Advanced™ outlet should be slid firmly onto the bottom down pipe until it can be pushed no further. (figure 3)
4. Screw the Leaf Eater Advanced™ into position through the screw slots provided. Ensure appropriate screws and anchors (if required) are used. (figure 5)
5. Insert the Cleanshield™ screen into the Leaf Eater Advanced™. Ensure the Cleanshield™ screen is sitting firmly in place and check installation is secure. (figure 6)

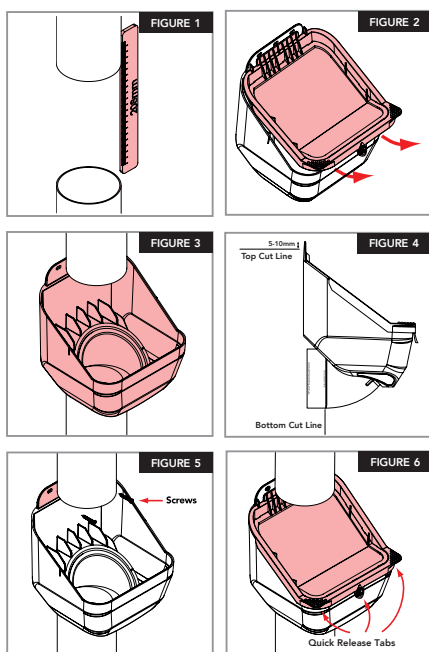

Horizontal (Rear Outlet) Installation

1. Using the quick release tabs remove the Cleanshield™ screen by lifting it up and then out. (Figure 2)
2. Swivel the outlet to the horizontal position – some force may be required.
3. Position the Leaf Eater Advanced™ next to existing pipework, mark and cut top and bottom cut lines as per figure 4 . Ensure the cut edge is clean and smooth.
4. Insert the Leaf Eater Advanced™ by sliding the rear outlet into the horizontal pipe. The back fixing plate must sit behind the top section of downpipe. (figure 3)
5. Screw the Leaf Eater Advanced™ into position through the screw slots provided. Ensure appropriate screws and anchors (if required) are used. (figure 5)
6. Insert the Cleanshield™ screen into the Leaf Eater Advanced™. Ensure the Cleanshield™ screen is sitting firmly in place and check installation is secure. (figure 6)

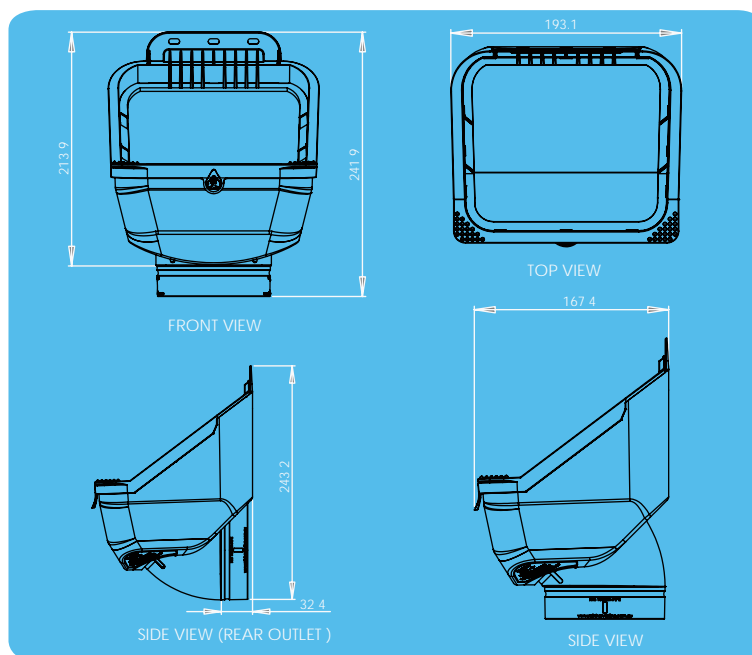

ALL DIMENSIONS IN MM UNLESS OTHERWISE STATED.

Maintenance

The Cleanshield™ screen is mostly self cleaning. If cleaning is required simply lift the Cleanshield™ screen out by taking hold of the quick release tabs and pull the Cleanshield™ screen upwards and outwards, then hose or brush off.