

REVISIONS

REV	DESCRIPTION	DATE	APVD
A	Revised	5/7/24	

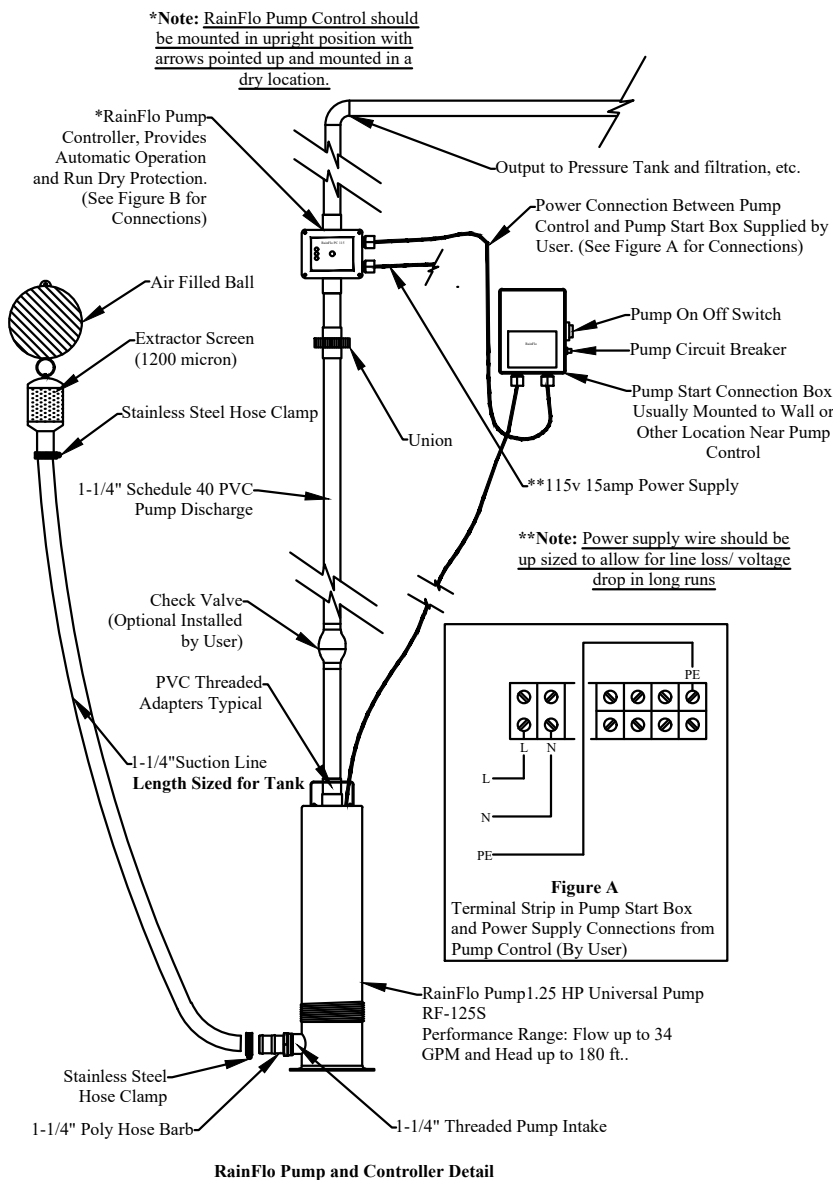

Legend	
1.	GRAF Carat S 700 Gallon Underground Tank.
2.	GRAF Optimax Pro Internal High efficiency, self-cleaning, In Tank filtration system.
3.	4" overflow drain to storm drain or other. Typically 4" PVC Sewer and Drain.
4.	1-1/4" Bulkhead Fitting for plumbing thru tank or riser assembly.
5.	Opticlean Sprayhead.
6.	Overflow siphon.
7.	GRAF Floating 1-1/4" Extractor with check valve.
8.	RainFlo 3/4 HP 115v Submersible Rainwater Pump High performance submersible rainwater pump with stainless steel base and 1-1/4" threaded inlet for use with a floating filter.
9.	4" Pipe Gasket.
10.	4" PVC from Roof Gutters and Downspouts (By Others).
11.	Tank Level Sensor for Aqua Control Device
12.	Calming inlet to prevent the disturbance of the fine sediment layer at bottom of tank.
13.	Adjustable Riser and Childproof Lid.
14.	4" PVC Pipe for Connection to Calming Inlet.
15.	Pump Output Line to Irrigation with Check Valve (By Others).
16.	Dome and Shaft Seal Gaskets.

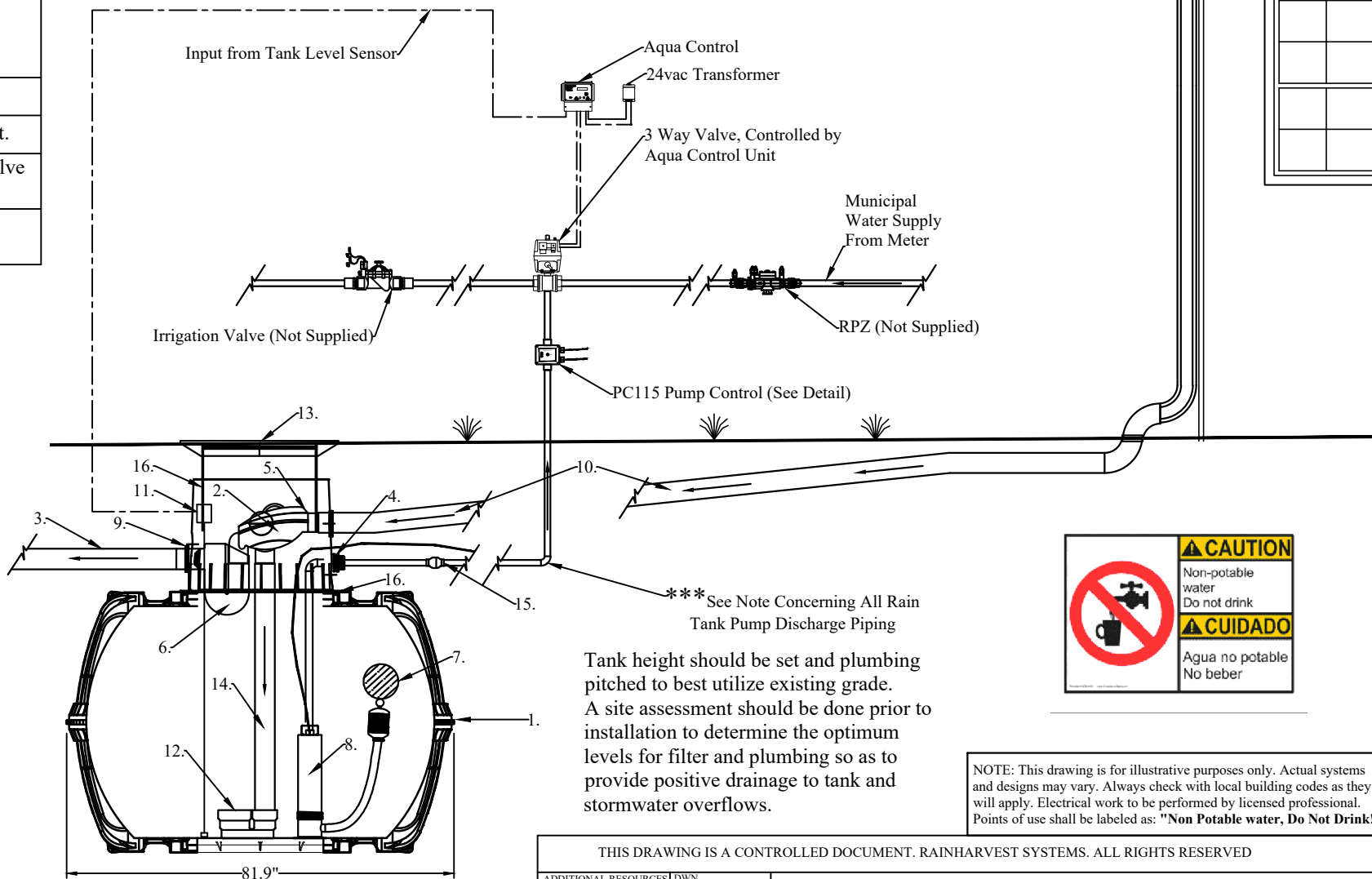
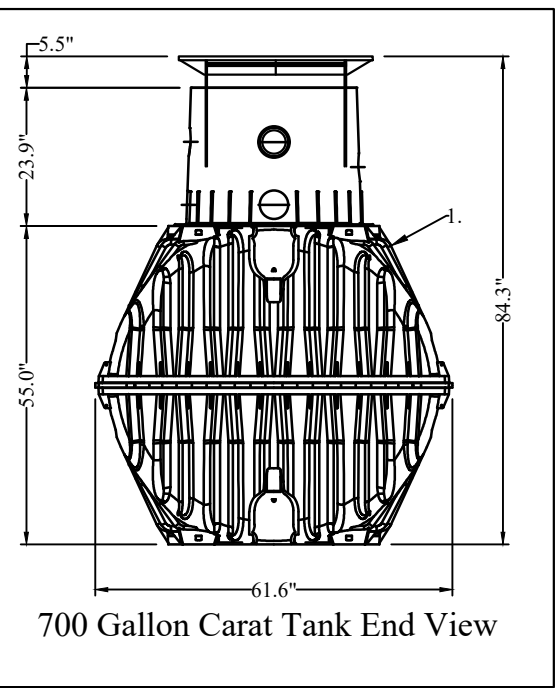

700 Gallon Carat Tank Cutaway Side View

GRAF Optimax High efficiency, Self-Cleaning, In Tank Filtration System:

- * Filter specially developed for rain water harvesting
- * Low maintenance; self cleaning
- * Only 6.5" height offset between inlet and outlet
- * 0.35mm (.01") mesh filter
- * Transparent cover for easy maintenance
- * Optional Opticlean® Sprayhead
- * Over 95% yield
- * Self-cleaning filter
- * Max. 3,750 sq. ft. with 4" connections
- * Space saving filter technology integrated in the tank

The ability of RainFlo UV disinfection systems to create potable quality water is dependent on incoming water quality. Refer to the RainFlo UV system product manual for incoming water quality requirements. RainHarvest Systems is not responsible for incoming water quality. Please check with your local authority for applicable codes and guidelines as the ability to use rainwater for potable applications varies by jurisdiction. The suitability of the water quality produced by the RainFlo UV disinfection systems for its intended use must be verified by the system owner through regular testing.

Important Information
Warning: Do not drink untreated rainwater. This system does not include disinfection, therefore is non-potable water. Refer to our filtration products for potable water solutions.
User shall determine the suitability of the product for the intended application before installation. NO WARRANTY of MERCHANTABILITY, FITNESS for PURPOSE, or OTHERWISE is explicit or implied. User assumes all risk and liability whatsoever in connection with, regardless of any employee's suggestions or statements, the system application or construction. Furthermore, consult local building codes for system use, conditions, restrictions, or requirements.

THIS DRAWING IS A CONTROLLED DOCUMENT. RAINHARVEST SYSTEMS. ALL RIGHTS RESERVED

ADDITIONAL RESOURCES	DWN	CMG	RainFlo Rainwater Collection System			
	CHK	CMG				
DIMENSIONS	INCHES	APVD	RainHarvest Systems LLC. 4475 Alicia Lane Cumming, GA 30028 Tel: 770-889-2533 www.rainharvest.com			
SH.#	WEIGHT	CMG				
1 OF 1	SIZE	B	SCALE	NTS	ITEM NO	QUOTE NUMBER



NOTE: This drawing is for illustrative purposes only. Actual systems and designs may vary. Always check with local building codes as they will apply. Electrical work to be performed by licensed professional. Points of use shall be labeled as: "Non Potable water, Do Not Drink!"