

Multi Tank Systems	
1.	GRAF Carat S 1700 Gallon Underground Tank
2.	GRAF Carat S 1700 Gallon Underground Extension Tank
3.	Telescoping Dome and Riser
4.	Drain Lines From Roof Gutters
5.	2" Schedule 40 PVC Pipe Tank Balancing Line
6.	2" Bulkhead Fitting
7.	Clean Water Inlet to tank From Optimax Filter
8.	Overflow Lines To Secondary Drains
9.	GRAF Optimax Rainwater Filter
10.	FI 2500 Pump Located In End Tank
11.	Floating Pump Extrator
12.	Tank Level Indicator Sensor
13.	Calming Inlet
14.	Overflow Siphon
15.	4" Multi Tite Gasket
16.	1-1/2" Pump Output Line
17.	2" Screened Tank Vent

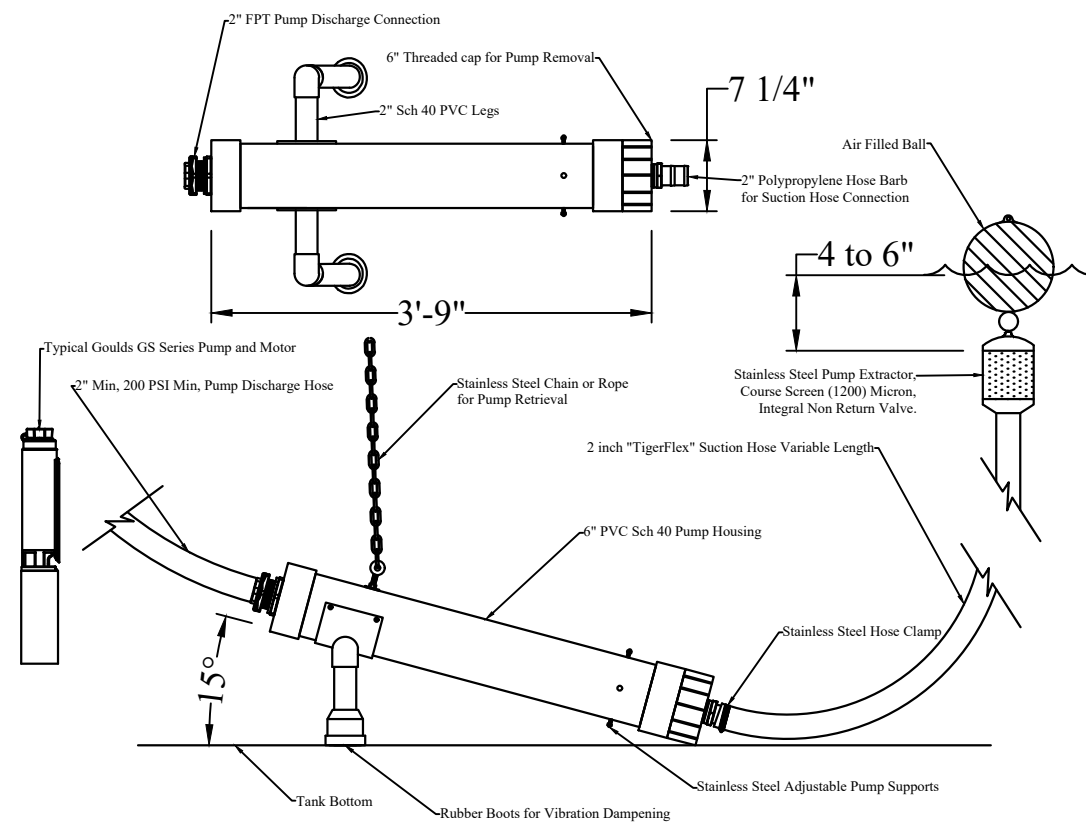

RainHarvest Flow Inducer for Goudds GS Pumps		Date	10-01-10
RainHarvest Systems LLC. 4075 Parkway North Dr Suite C Cumming, GA 30009 Tel: 770-889-2533 Fax: 770-889-2577		Drawn By	CMG

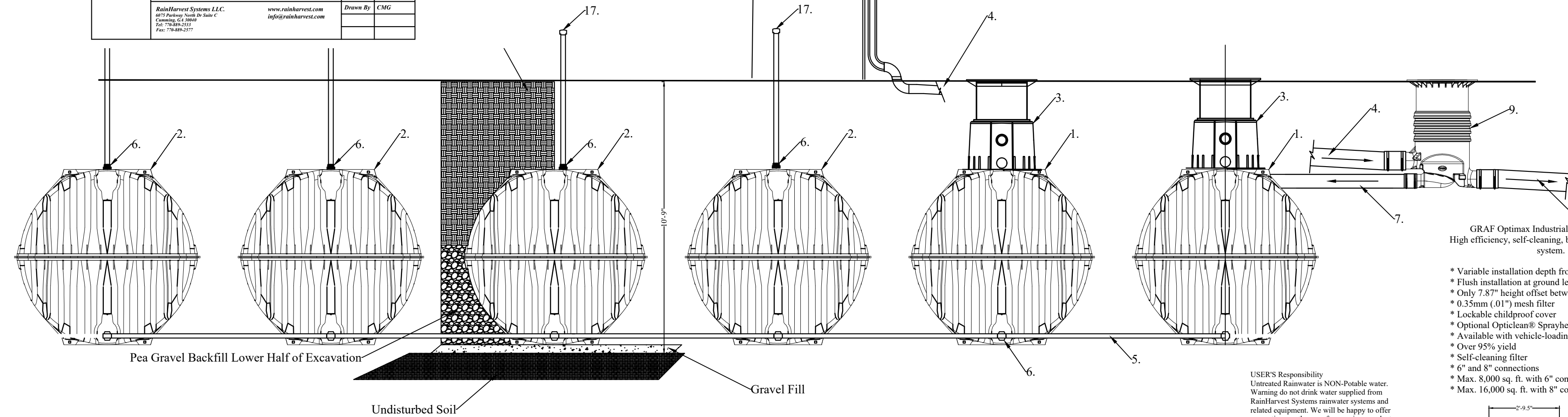

**GRAF Carat S 1700 Gallon Tank Specifications:**

- \*Variable burial depth: 30" to 42" (59" Max. with optional dome extension and "Maxi" telescopic riser)
- \*Unique fit accuracy of the components thanks to new production process
- \*Consistent quality due to TÜV safety testing and production monitoring
- \*Vehicle-bearing (with telescopic cast iron manway kit)
- \*Groundwater stable up to the middle of the tank due to extremely rigid construction
- \*Can be expanded as required
- \*31.5" Manway opening

**USER'S Responsibility**  
 Untreated Rainwater is NON-Potable water. Warning do not drink water supplied from RainHarvest Systems rainwater systems and related equipment. We will be happy to offer suggestions on the use of our various products either by way of printed material or through direct contact with RainHarvest Systems team members. However, since we have no control over the use of our products once they are shipped, NO WARRANTY WHETHER OF MERCHANTABILITY, FITNESS FOR PURPOSE, OR OTHERWISE is made beyond the repair, replacement, or refund of purchase price at the sole discretion of RainHarvest Systems. Users shall determine the suitability of the product for the intended application before using, and the users assume all risk and liability whatsoever in connection therewith, regardless of any team members suggestions or statements as to the application or construction. In no event shall any remedy exceed the purchase price of the product. Consult local building codes for the system use.

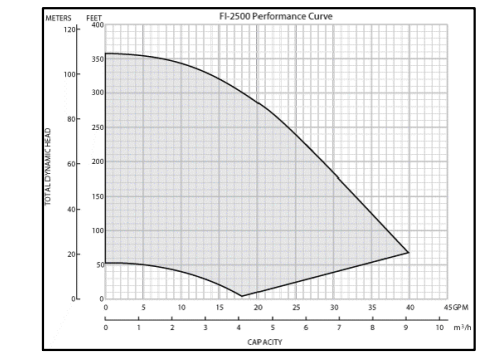

**GRAF Optimax Industrial Rainwater Filter**  
 High efficiency, self-cleaning, below ground filtration system.

- \* Variable installation depth from 28-59 inches
- \* Flush installation at ground level
- \* Only 7.87" height offset between inlet and outlet
- \* 0.35mm (.01") mesh filter
- \* Lockable childproof cover
- \* Optional Opticlean® Sprayhead
- \* Available with vehicle-loading cast iron lid
- \* Over 95% yield
- \* Self-cleaning filter
- \* 6" and 8" connections
- \* Max. 8,000 sq. ft. with 6" connections
- \* Max. 16,000 sq. ft. with 8" connections

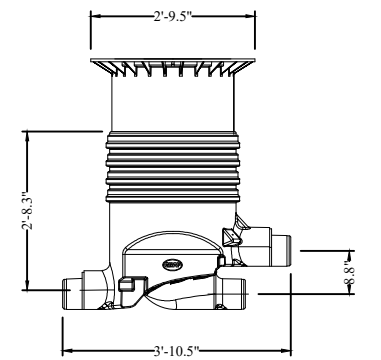

Tank height will be set and plumbing pitched to best utilize existing grade. A site assessment should be done prior to installation to determine the optimum levels for filter and plumbing so as to provide positive drainage to tank and stormwater overflows.

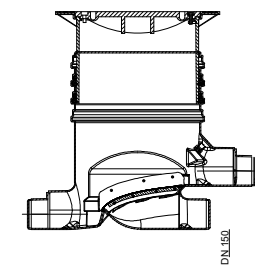

NOTE: This drawing is for illustrative purposes only. Actual systems and designs may vary. Always check with local building codes as they will apply. Electrical work to be performed by licensed professional. Points of use shall be labeled as: "Non Potable water, Do Not Drink"

CHK BY:	APP BY:	DRAWN BY:	CMG	QUOTE NO.:	SHEET:
					1 OF 1
<b>RainFlo 10,200 Gallon Graf Rainwater Collection System</b>					
		RainHarvest Systems LLC. 4475 Alicia Lane Suite 100 Cumming, GA 30028 Tel: 770-889-2533 Fax: 770-889-2577			