

Guide Wire System - Installation Instructions



The Guide wire system is recommended for use with all Liquilevel tank level indicator installations.

The system includes: A) (1) 16 foot or 32 foot guide wire and wire fastener, B) (1) M6 eyelet/ground anchor, C) (1) black plastic eye bolt, D) (1) black plastic hex nut, E) (2) M6 stainless steel hex nuts, F) (2) M6 stainless steel flat washers.

When ordering a guide wire system separately from the Liquilevel system, all parts (A - F) will need to be assembled. When the guide wire system is included with the Liquilevel system, Parts C and D will already be assembled to the Liquilevel level indicator.



1
The Liquilevel system has to be installed first, using the installation template and instructions.

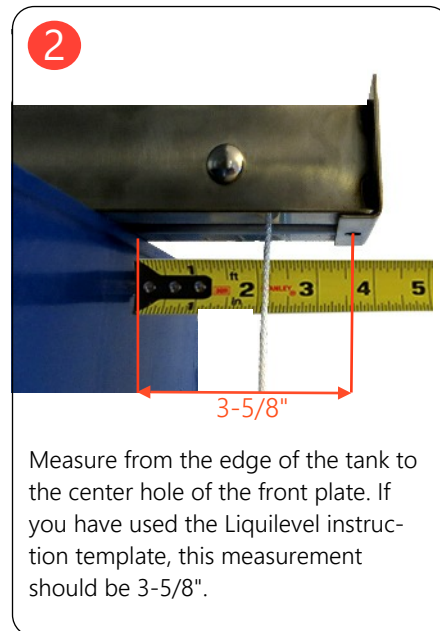

2
Measure from the edge of the tank to the center hole of the front plate. If you have used the Liquilevel instruction template, this measurement should be 3-5/8".



3
Using (1) M6 stainless steel nut and washer, thread the nut half way up stud of guide wire, as shown above.



4
Insert guide wire stud through base-plate center hole and thread nut and washer and fasten. Use long nose pliers to hold nut in place.

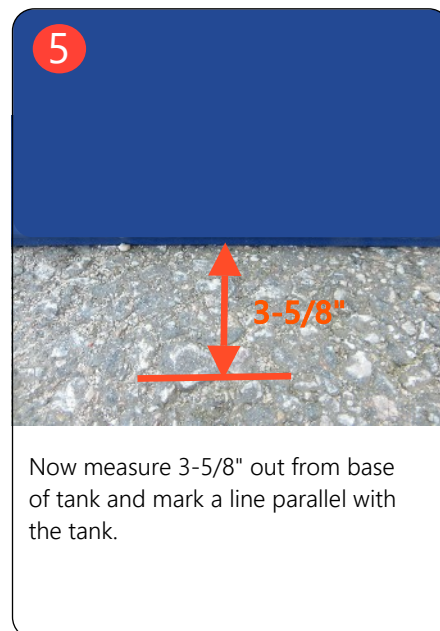

5
Now measure 3-5/8" out from base of tank and mark a line parallel with the tank.

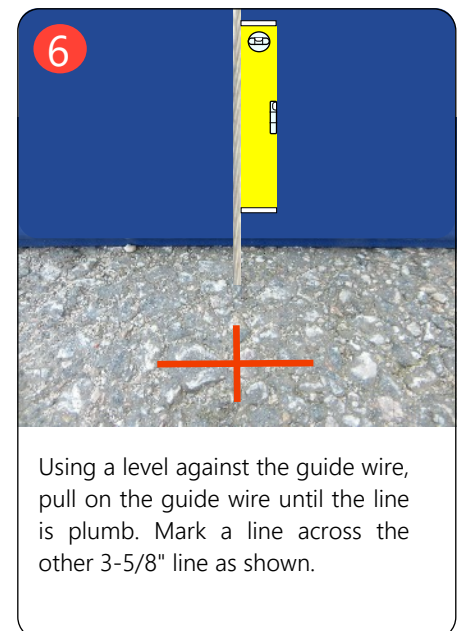

6
Using a level against the guide wire, pull on the guide wire until the line is plumb. Mark a line across the other 3-5/8" line as shown.

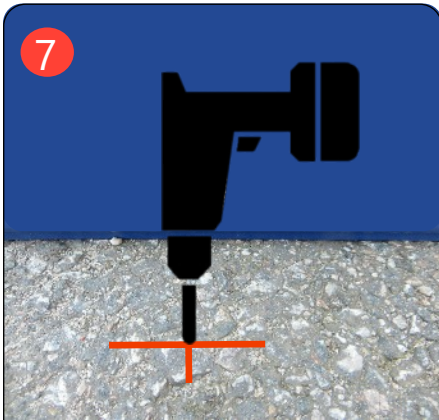

Using a 1/2" masonry drill bit, drill a hole in the concrete. The depth of the hole should be at least 3" deep

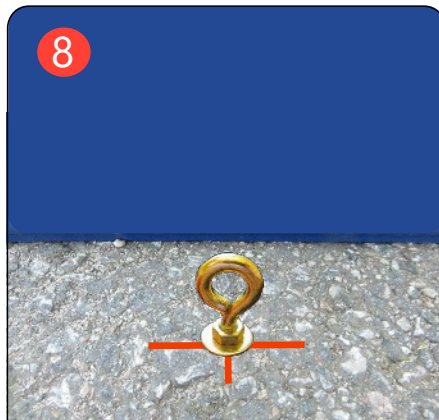

Loosen the anchor slightly by unwinding the eyebolt. Insert the M6 anchor into the hole. Using a wrench, tighten until the anchor is secured firmly into the concrete.



Remove level indicator cap. The level indicator has internal ribs which strengthen the indicator. The hole for the plastic eyebolt should be drilled centrally between these ribs, so that the plastic nut fits between the ribs



Drill a 1/4" hole through the level indicator through the shoulder/mold line. This line is the correct height for the eyebolt.



Insert plastic eyebolt and fasten with plastic hex nut. (White eyebolt for illustration purposes only) Re-insert the indicator plastic cap. Now insert the guide wire through the eyebolt.

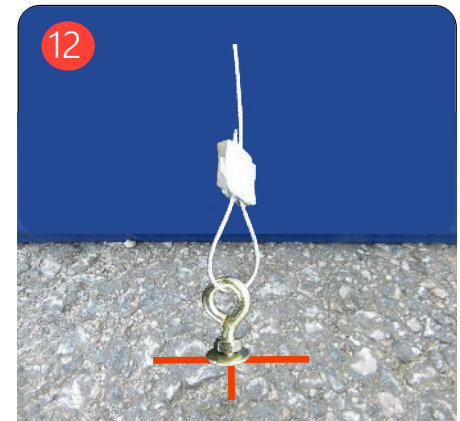

Loop the guide wire first through the fastener, then through the eyebolt and back into the fastener. Pull tight and adjust fastener accordingly. See Step-14 for more detail.



Pull tight and adjust fastener accordingly.

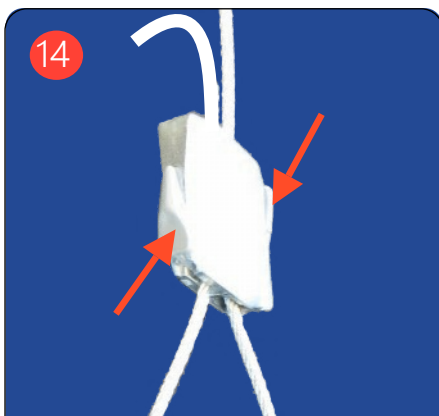

Adjust guide wire by using the release buttons on the side of the guide wire fastener. Any excess wire can be cut off.



Using a wrench, rotate the stud until the guide wire is plumb and taught. (DO NOT OVER-TIGHTEN) Finalize installation using a wrench to tighten the stud to the baseplate.